



**IES INDOOR REPORT
PHOTOMETRIC FILENAME : LLI080811E.IES**

DESCRIPTION INFORMATION (From Photometric File)

IESNA:LM-63-2002
[TEST] LLI 0808-11E
[TESTLAB] LIGHT LABORATORY INC
[ISSUEDATE] 9/24/2008
[MANUFAC] CRYSTAL LIGHTING CORP.
[LUMCAT] CL-02
[LUMINAIRE] 8-3/4"L. X 4"D. X 12"H. WALL SCONCE
[MORE] WHITE REFLECTOR
[MORE] WHITE DIFFUSED LENS
[BALLASTCAT] ADVANCE ICF-2S26-H1-LD
[BALLAST] 120 TO 277V 50/60Hz ELECTRONIC
[LAMPPOSITION] 0,0
[LAMPCAT] GE F26DBXT4/SPX27/4P
[_LAMPLUM] 1710
[_INPUT] 120VAC, 57.15W

CHARACTERISTICS

Total Rated Lamp Lumens	3420 (2 lamps)
Total Luminaire Efficiency	83.4 %
Luminaire Efficacy Rating (LER)	50
Total Luminaire Watts	57
Ballast Factor	1.00
CIE Type	Semi-Direct
Spacing Criteria (0-180)	3.16
Spacing Criteria (90-270)	2.82
Spacing Criteria (Diagonal)	2.40
Basic Luminous Shape	Rectangular w/Sides
Luminous Length (0-180)	0.33 ft
Luminous Width (90-270)	0.71 ft
Luminous Height	1.00 ft

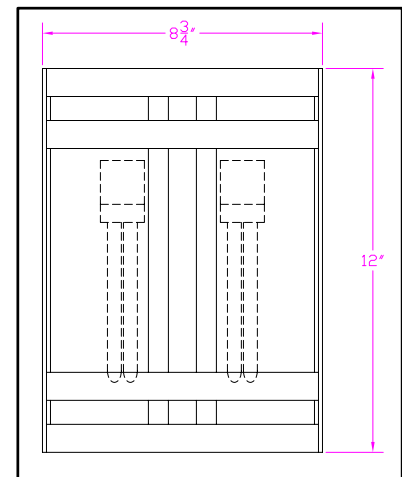

LUMINANCE DATA (cd/sq.m)

Angle In Degrees	Average 0-Deg	Average 45-Deg	Average 90-Deg
45	7682	7654	11454
55	6699	5999	9194
65	6329	5156	7023
75	6224	4868	5839
85	6236	4613	5575

IES INDOOR REPORT
PHOTOMETRIC FILENAME : LLI080811E.IES

CANDELA TABULATION

	<u>0</u>	<u>5</u>	<u>15</u>	<u>25</u>	<u>35</u>	<u>45</u>	<u>55</u>	<u>65</u>	<u>75</u>	<u>85</u>
0	137	137	137	137	137	137	137	137	137	137
5	222	224	223	221	216	209	200	191	184	182
15	469	472	478	479	474	461	438	403	357	329
25	542	547	554	561	569	575	569	545	492	431
35	519	522	527	536	552	571	591	602	572	487
45	477	474	472	472	477	488	503	521	519	455
55	446	445	437	426	416	411	409	411	410	372
65	437	438	427	408	388	367	346	318	305	277
75	432	431	419	398	375	349	310	291	260	224
85	422	422	409	387	361	323	304	273	240	201
90	427	426	413	391	363	335	292	271	236	196
95	427	426	412	390	362	334	290	269	235	196
105	411	410	397	375	350	312	293	262	229	192
115	386	384	373	353	321	305	278	250	219	185
125	345	346	335	318	298	277	253	229	203	174
135	299	299	291	277	262	246	228	211	193	172
145	246	246	241	234	229	226	223	221	217	193
155	206	207	207	212	225	246	258	250	217	175
165	174	175	179	183	179	167	155	143	126	116
175	39	39	40	40	42	44	46	47	48	50
180	26	26	26	26	26	26	26	26	26	26

Vert. Angles **Horizontal Angles**

	<u>90</u>	<u>95</u>	<u>105</u>	<u>115</u>	<u>125</u>	<u>135</u>	<u>145</u>	<u>155</u>	<u>165</u>	<u>175</u>
0	137	137	137	137	137	137	137	137	137	137
5	179	177	170	163	156	151	147	143	141	140
15	322	298	282	262	240	233	228	223	220	219
25	416	390	341	289	284	274	261	245	241	240
35	460	422	337	286	277	264	244	226	218	214
45	425	386	279	253	235	213	193	182	177	174
55	346	283	240	202	178	155	136	127	123	121
65	260	238	191	154	125	101	85	80	80	79
75	206	187	148	112	84	63	49	46	46	46
85	181	161	121	84	66	28	18	15	15	15
90	176	156	114	76	57	17	9	6	6	6
95	175	156	115	77	59	20	11	8	8	8
105	173	155	117	82	65	33	18	16	17	16
115	168	151	117	84	68	38	24	23	22	23
125	160	146	115	87	64	53	34	29	29	29
135	163	152	123	95	75	58	47	46	47	48
145	179	169	139	111	95	80	68	70	73	74
155	163	160	146	130	121	109	95	88	81	77
165	115	117	123	125	128	127	110	95	89	87
175	51	52	55	56	58	59	60	61	63	64
180	26	26	26	26	26	26	26	26	26	26

Vert. Angles **Horizontal Angles**

	<u>180</u>
0	137
5	140
15	219
25	240

**IES INDOOR REPORT
PHOTOMETRIC FILENAME : LLI080811E.IES**

CANDELA TABULATION - (Cont.)

35	213
45	174
55	121
65	79
75	46
85	15
90	6
95	8
105	17
115	23
125	30
135	48
145	74
155	76
165	87
175	64
180	26

IES INDOOR REPORT
PHOTOMETRIC FILENAME : LLI080811E.IES

ZONAL LUMEN SUMMARY

Zone	Lumens	%Lamp	%Fixt
0-30	193.68	5.7	6.8
0-40	419.71	12.3	14.7
0-60	966.75	28.3	33.9
0-90	1780.39	52.1	62.4
90-120	491.28	14.4	17.2
90-130	655.62	19.2	23
90-150	905.88	26.5	31.8
90-180	1070.82	31.3	37.6
0-180	2851.2	83.4	100

Total Luminaire Efficiency = 83.4%

ZONAL LUMEN SUMMARY

Zone	Lumens
0-10	3.79
10-20	49.33
20-30	140.57
30-40	226.03
40-50	272.33
50-60	274.71
60-70	256.08
70-80	235.75
80-90	321.8
90-100	102.62
100-110	201.19
110-120	187.48
120-130	164.34
130-140	137.26
140-150	113
150-160	89.89
160-170	56.44
170-180	18.61

IES INDOOR REPORT
PHOTOMETRIC FILENAME : LLI080811E.IES

COEFFICIENTS OF UTILIZATION - ZONAL CAVITY METHOD

Effective Floor Cavity Reflectance 0.20

RC	80				70				50			30			10			0
	RW	70	50	30	10	70	50	30	10	50	30	10	50	30	10	50	30	
0	92	92	92	92	86	86	86	86	75	75	75	65	65	65	56	56	56	52
1	80	74	69	65	74	69	65	61	60	56	53	51	48	46	43	41	39	35
2	71	63	56	50	66	58	52	47	50	45	41	43	39	36	36	33	30	27
3	64	54	46	40	59	50	43	38	43	38	33	37	32	28	31	27	24	21
4	58	47	39	33	53	44	36	31	38	32	27	32	27	23	27	23	20	17
5	53	41	33	27	49	38	31	26	33	27	23	28	23	19	23	20	16	14
6	48	37	29	23	45	34	27	22	29	23	19	25	20	16	21	17	14	11
7	44	33	25	20	41	30	23	19	26	21	16	22	18	14	19	15	12	10
8	41	29	22	17	38	27	21	16	24	18	14	20	16	12	17	13	10	8
9	38	27	20	15	35	25	18	14	22	16	12	18	14	11	16	12	9	7
10	35	24	17	13	33	23	16	12	20	14	11	17	12	9	14	11	8	6

POLAR GRAPH

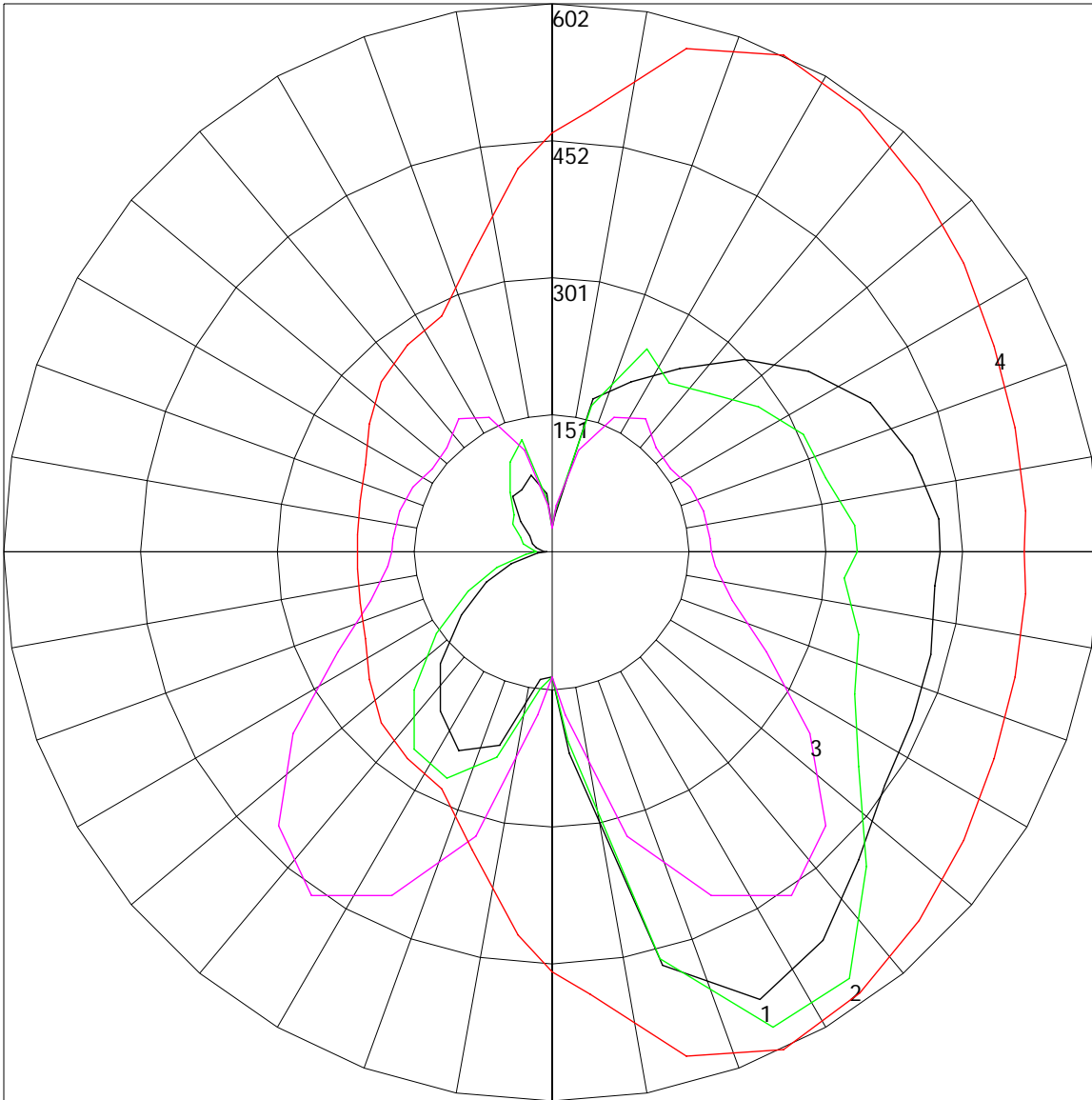

Maximum Candela = 602 Located At Horizontal Angle = 65, Vertical Angle = 35

- # 1 - Vertical Plane Through Horizontal Angles (0 - 180) : BLACK
- # 2 - Vertical Plane Through Horizontal Angles (45 - 225) : GREEN
- # 3 - Vertical Plane Through Horizontal Angles (90 - 270) : MAGENTA
- # 4 - Horizontal Cone Through Vertical Angle (35) (Through Max. Cd.) : RED

NOTE: ALL TESTS ASSUME BALLAST FACTOR (BF) = 1.0 UNLESS STATED.
IF TEST OR OTHER BALLAST USED HAS A BF OTHER THAN 1.0, ALL
LUMEN, CANDELA, AND LUMINANCE VALUES SHOULD BE MULTIPLIED BY
THE BF, CU, EFFICIENCY AND % FLUX VALUES REMAIN AS LISTED.
TOTAL WATTS VALUE APPLIES ONLY TO TESTED BALLAST.