



**IES INDOOR REPORT
PHOTOMETRIC FILENAME : LLI080811C.IES**

DESCRIPTION INFORMATION (From Photometric File)

IESNA:LM-63-2002
[TEST] LLI 0808-11C
[TESTLAB] LIGHT LABORATORY INC
[ISSUEDATE] 9/24/2008
[MANUFAC] CRYSTAL LIGHTING CORP.
[LUMCAT] CLW-2078-42T
[LUMINAIRE] 10"L. X 11"D. X 11-1/2"H. WALL SCONCE
[MORE] WHITE REFLECTOR
[MORE] CLEAR PATTERNED LENS
[BALLASTCAT] ADVANCE ICF-2S26-H1-LD
[BALLAST] 120 TO 277V 50/60Hz ELECTRONIC
[LAMPPOSITION] 90,90
[LAMPCAT] PHILIPS PL-T 42W/830/4P/ALTO
[_LAMPLUM] 3200
[_INPUT] 120VAC, 47.80W

CHARACTERISTICS

Total Rated Lamp Lumens	3200
Total Luminaire Efficiency	44.2 %
Luminaire Efficacy Rating (LER)	30
Total Luminaire Watts	48
Ballast Factor	1.00
CIE Type	Direct
Spacing Criteria (0-180)	1.34
Spacing Criteria (90-270)	1.08
Spacing Criteria (Diagonal)	1.16
Basic Luminous Shape	Rectangular
Luminous Length (0-180)	0.65 ft
Luminous Width (90-270)	0.67 ft
Luminous Height	0.00 ft

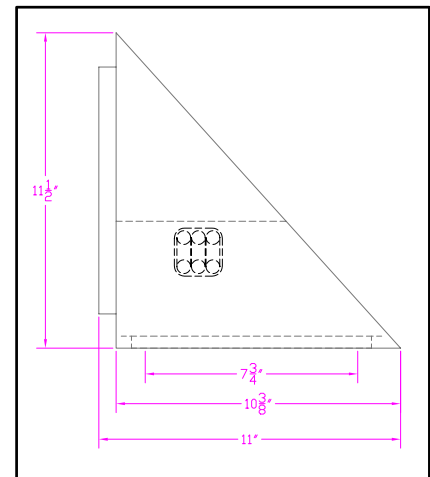

LUMINANCE DATA (cd/sq.m)

Angle In Degrees	Average 0-Deg	Average 45-Deg	Average 90-Deg
45	14667	12956	10162
55	9945	8825	7319
65	7187	5843	5551
75	7537	6011	5152
85	10200	7083	5383

CANDELA TABULATION

	<u>0.0</u>	<u>22.5</u>	<u>45.0</u>	<u>67.5</u>	<u>90.0</u>	<u>112.5</u>	<u>135.0</u>	<u>157.5</u>	<u>180.0</u>
0	748	748	748	748	748	748	748	748	748
5	775	772	765	753	741	730	721	715	713
15	798	788	760	724	690	662	640	625	619
25	760	744	698	641	591	550	514	488	479
35	635	612	559	500	453	411	375	346	337
45	420	406	371	319	291	263	238	217	211
55	231	219	205	187	170	150	136	130	127
65	123	117	100	97	95	83	73	77	81
75	79	72	63	54	54	49	46	49	54
85	36	34	25	21	19	17	16	22	22
90	0	0	0	0	0	0	0	0	0

IES INDOOR REPORT
PHOTOMETRIC FILENAME : LLI080811C.IES

ZONAL LUMEN SUMMARY

Zone	Lumens	%Lamp	%Fixt
0-30	399.46	12.5	28.2
0-40	693.38	21.7	49
0-60	1163.61	36.4	82.2
0-90	1415.48	44.2	100
90-120	0	0	0
90-130	0	0	0
90-150	0	0	0
90-180	0	0	0
0-180	1415.48	44.2	100

Total Luminaire Efficiency = 44.2%

ZONAL LUMEN SUMMARY

Zone	Lumens
0-10	17.82
10-20	137.15
20-30	244.49
30-40	293.92
40-50	271.15
50-60	199.08
60-70	125.68
70-80	77.03
80-90	49.17
90-100	0
100-110	0
110-120	0
120-130	0
130-140	0
140-150	0
150-160	0
160-170	0
170-180	0

IES INDOOR REPORT
PHOTOMETRIC FILENAME : LLI080811C.IES

COEFFICIENTS OF UTILIZATION - ZONAL CAVITY METHOD

Effective Floor Cavity Reflectance 0.20

RC RW	80				70				50			30			10			0
	70	50	30	10	70	50	30	10	50	30	10	50	30	10	50	30	10	0
0	53	53	53	53	51	51	51	51	49	49	49	47	47	47	45	45	45	44
1	48	46	44	42	47	45	43	42	43	42	40	41	40	39	40	39	38	37
2	44	40	37	35	43	39	37	34	38	36	34	36	35	33	35	34	32	31
3	40	36	32	29	39	35	32	29	34	31	28	32	30	28	31	29	27	26
4	37	32	28	25	36	31	27	25	30	27	24	29	26	24	28	26	24	23
5	34	28	24	21	33	28	24	21	27	24	21	26	23	21	25	23	21	20
6	31	25	22	19	30	25	21	19	24	21	18	23	21	18	23	20	18	17
7	29	23	19	16	28	23	19	16	22	19	16	21	18	16	21	18	16	15
8	27	21	17	15	26	21	17	15	20	17	15	20	17	14	19	16	14	13
9	25	19	16	13	24	19	15	13	18	15	13	18	15	13	17	15	13	12
10	23	18	14	12	23	17	14	12	17	14	12	17	14	12	16	13	12	11

POLAR GRAPH

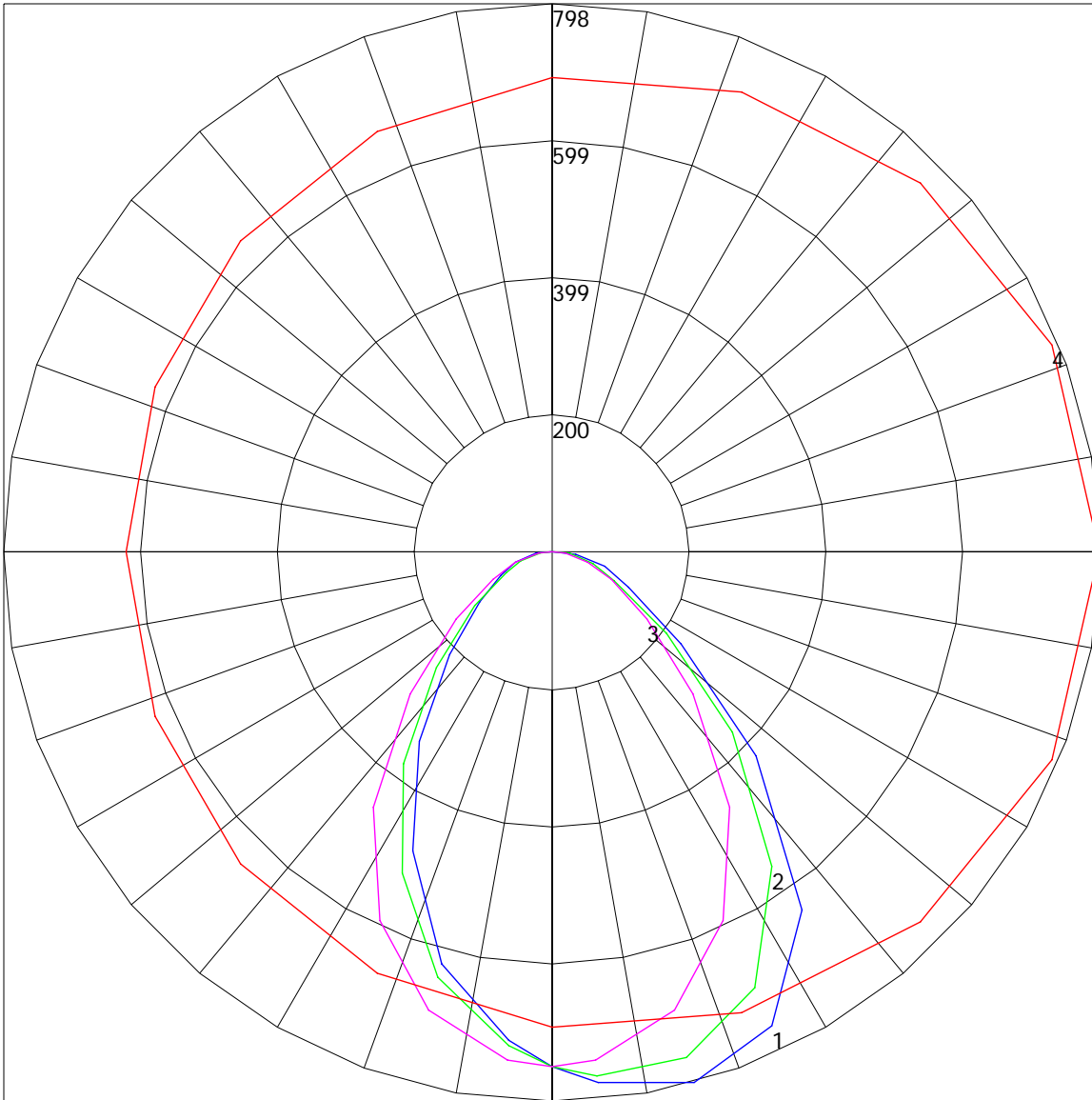

- Maximum Candela = 798 Located At Horizontal Angle = 0, Vertical Angle = 15
- # 1 - Vertical Plane Through Horizontal Angles (0 - 180) (Through Max. Cd.) : BLUE
 - # 2 - Vertical Plane Through Horizontal Angles (45 - 225) : GREEN
 - # 3 - Vertical Plane Through Horizontal Angles (90 - 270) : MAGENTA
 - # 4 - Horizontal Cone Through Vertical Angle (15) (Through Max. Cd.) : RED

NOTE: ALL TESTS ASSUME BALLAST FACTOR (BF) = 1.0 UNLESS STATED.
IF TEST OR OTHER BALLAST USED HAS A BF OTHER THAN 1.0, ALL
LUMEN, CANDELA, AND LUMINANCE VALUES SHOULD BE MULTIPLIED BY
THE BF, CU, EFFICIENCY AND % FLUX VALUES REMAIN AS LISTED.
TOTAL WATTS VALUE APPLIES ONLY TO TESTED BALLAST.