

CLP-Decorative Arms
Architectural Arms
DESIGN-FUNCTION-QUALITY

Crystal Lighting Corp.



Decorative Arm 1 is constructed of Extruded Aluminum Tubing. Mount over Round Poles or Tenons of 3", 3-1/2", 4", 4-1/2", or 5" OD, DA1 and is secured with 3/8" Stainless Steel Set Screws. Contact us for custom configuration or others mounting. All Decorative Arms are Proudly Designed, Fabricated and Assembled in the USA.

DA1-SGL



DA1-D180



DA1-WM

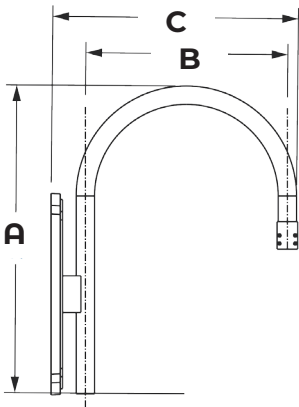
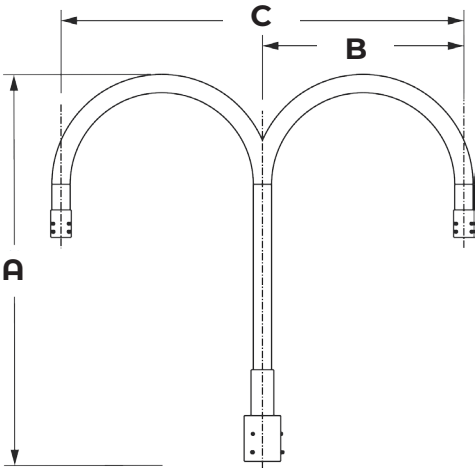
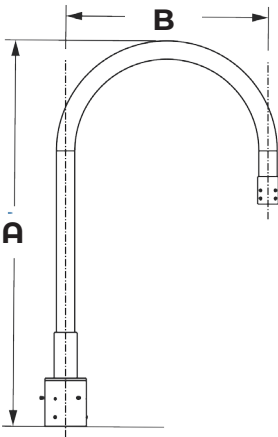

Dimensions				EPA
Cat#	A	B	C	EPA
DA1-SGL	42"	22"	-	1.16
DA1-D180	42"	22"	44"	1.33
DA1-WM	33" 1/2	22"	27" 3/4	1.22

Example: (DA1-SGL-3-BLK)

DA-1			
Cat #	Mounting	Diameter (Pole or Tenon)	Color
Decorative Arm 1 (DA1)	Single (SGL)	3" OD (3)	Black (BLK)
	Double 180° (D180)	3 1/2 OD (312)	White (WH)
	Wall Mount (WM)	4" OD (4)	Bronze (BRZ)
		4 1/2 OD (412)	Silver (SIL)
		5"OD (5)	Graphite (GPH)
			Custom (CST)

Decorative Arm 2 is Constructed of Extruded Aluminum Tubing. Mount over Round Poles or Tenons of 3", 3-1/2", 4", 4-1/2", or 5" OD, DA2 and is secured with 3/8" Stainless Steel Set Screws. Contact us for custom configuration or others mounting. All Decorative Arms are Proudly Designed, Fabricated and Assembled in the USA.

DA2-SGL

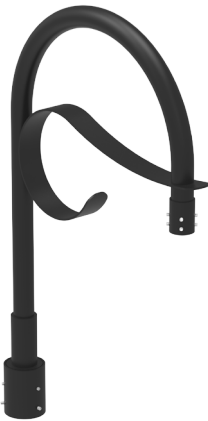

DA2-D180



DA2-WM

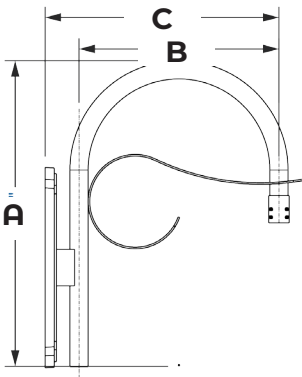
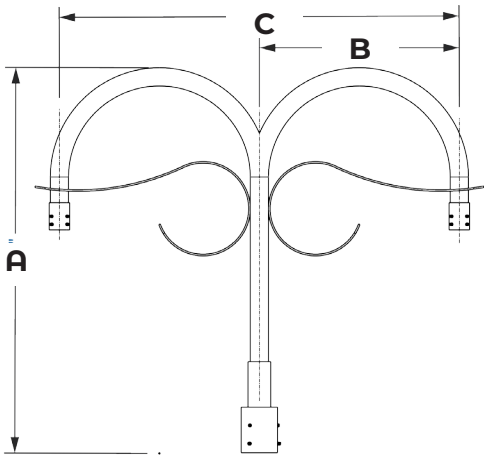
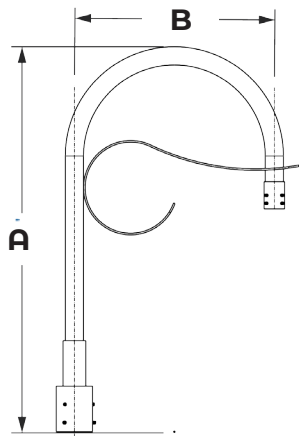

Dimensions				EPA
Cat#	A	B	C	EPA
DA2-SGL	42"	22"	-	1.18
DA2-D180	42"	22"	44"	1.36
DA2-WM	33" 1/2	22"	27" 3/4	1.25

Example: (DA2-SGL-3-BLK)

DA-2			
Cat #	Mounting	Diameter (Pole or Tenon)	Color
Decorative Arm 2 (DA2)	Single (SGL)	3" OD (3)	Black (BLK)
	Double 180° (D180)	3" 1/2 OD (312)	White (WH)
		4" OD (4)	Bronze (BRZ)
	Wall Mount (WM)	4" 1/2 OD (412)	Silver (SIL)
		5"OD (5)	Graphite (GPH) Custom (CST)

Decorative Arm 3 is Constructed of Extruded Aluminum Tubing. Mount over Round Poles or Tenons of 3", 3-1/2", 4", 4-1/2", or 5" OD, **DA3** and is secured with 3/8" Stainless Steel Set Screws. Contact us for custom configuration or others mounting. All Decorative Arms are Proudly Designed, Fabricated and Assembled in the USA.

DA3-SGL

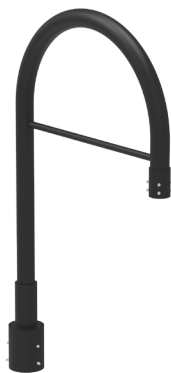

DA3-D180



DA3-WM

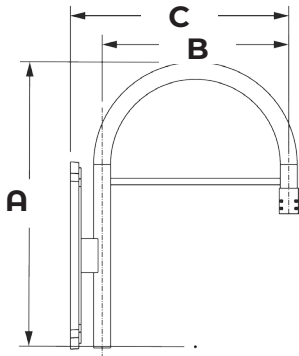
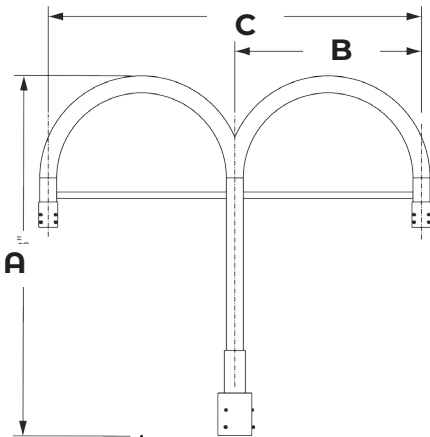
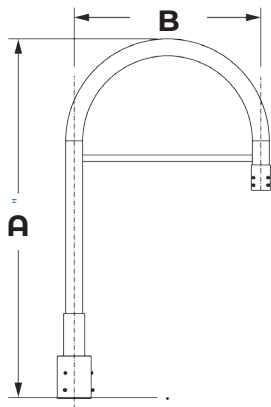

Dimensions				EPA
Cat#	A	B	C	EPA
DA2-SGL	42"	22"	-	1.18
DA2-D180	42"	22"	44"	1.35
DA2-WM	33" 1/2	22"	27" 3/4	1.26

Example: (DA3-SGL-3-BLK)

DA-3			
Cat #	Mounting	Diameter (Pole or Tenon)	Color
Decorative Arm 3 (DA3)	Single (SGL)	3" OD (3)	Black (BLK)
	Double 180° (D180)	3 1/2 OD (312)	White (WH)
		4" OD (4)	Bronze (BRZ)
	Wall Mount (WM)	4 1/2 OD (412)	Silver (SIL)
		5"OD (5)	Graphite (GPH)
			Custom (CST)

Decorative Arm 4 is Constructed of Extruded Aluminum Tubing. Mount over Round Poles or Tenons of 3-1/2" or 4" OD, **DA4** and is secured with 3/8" Stainless Steel Set Screws. Contact us for custom configuration or others mounting. All Decorative Arms are Proudly Designed, Fabricated and Assembled in the USA.

DA4-SGL

DA4-D180

DA4-WM

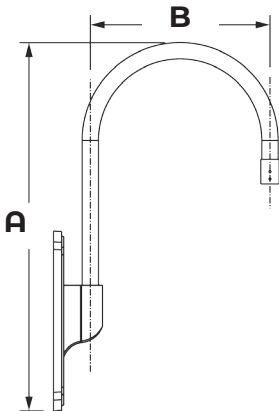
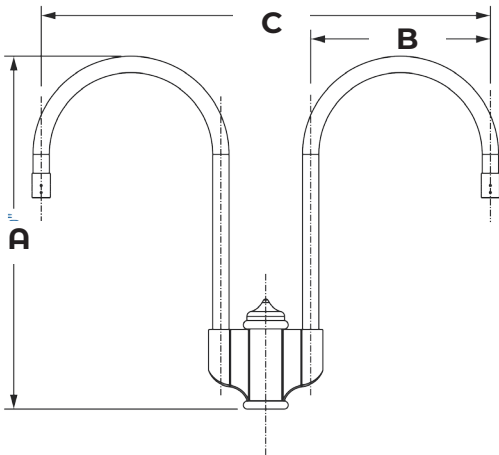
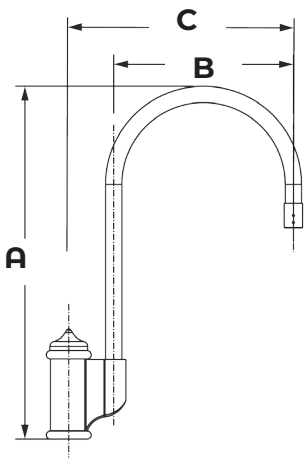

Dimensions				EPA
Cat#	A	B	C	EPA
DA4-SGL	43"	22"	27" 1/2	1.2
DA4-D180	43"	22"	55"	2.5
DA4-WM	45"	22"	26" 1/2	1.4

Example: (DA4-SGL-3-BLK)

DA-4			
Cat #	Mounting	Diameter (Pole or Tenon)	Color
Decorative Arm 4 (DA4)	Single (SGL)	3" 1/2 OD (312) 4" OD (4)	Black (BLK)
	Double 180° (D180)		White (WH)
	Wall Mount (WM)		Bronze (BRZ)
			Silver (SIL)
			Graphite (GPH)
		Custom (CST)	

Decorative Arm 5 is Constructed of Extruded Aluminum Tubing. Mount over Round Poles or Tenons of 3-1/2" or, 4" OD, **DA5** and is secured with 3/8" Stainless Steel Set Screws. Contact us for custom configuration or others mounting. All Decorative Arms are Proudly Designed, Fabricated and Assembled in the USA.

DA5-SGL



DA5-D180



DA5-wm

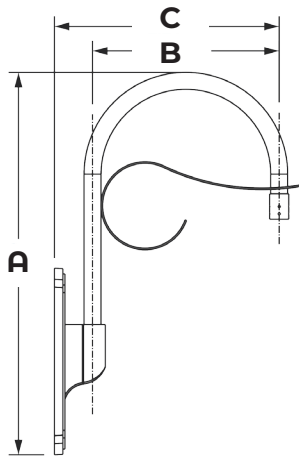
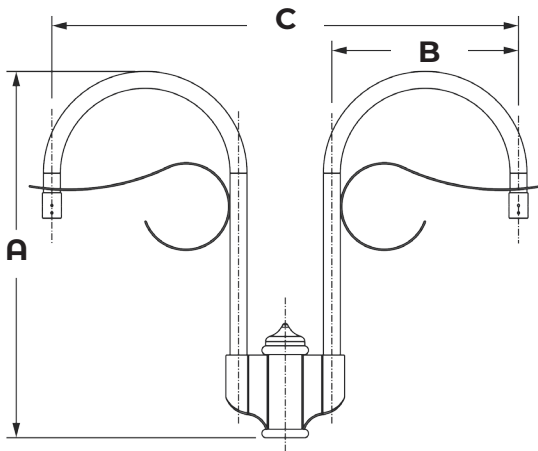
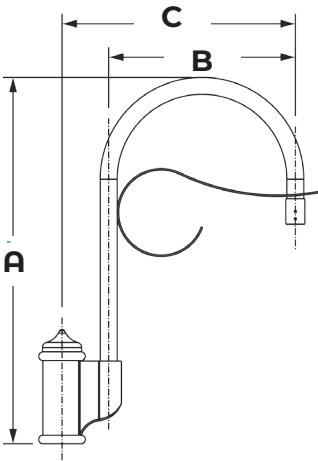

Dimensions				EPA
Cat#	A	B	C	EPA
DA5-SGL	43"	22"	27" 1/2	1.23
DA5-D180	43"	22"	55"	1.53
DA5-WM	45"	22"	26" 1/2	1.43

Example: (DA5-SGL-3-BLK)

DA5			
Cat #	Mounting	Diameter (Pole or Tenon)	Color
Decorative Arm 5 (DA5)	Single (SGL)	3" 1/2 OD (312) 4" OD (4)	Black (BLK)
	Double 180° (D180)		White (WH)
	Wall Mount (WM)		Bronze (BRZ)
			Silver (SIL)
			Graphite (GPH)
			Custom (CST)

Decorative Arm 6 is Constructed of Extruded Aluminum Tubing. Mount over Round Poles or Tenons of 3", 3-1/2", 4", 4-1/2", or 5" OD, **DA6** and is secured with 3/8" Stainless Steel Set Screws. Contact us for custom configuration or others mounting. All Decorative Arms are Proudly Designed, Fabricated and Assembled in the USA.

DA6-SGL



DA6-D180



DA6-wm

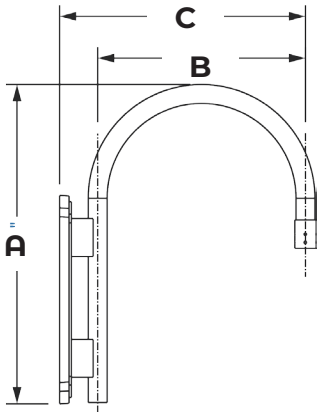
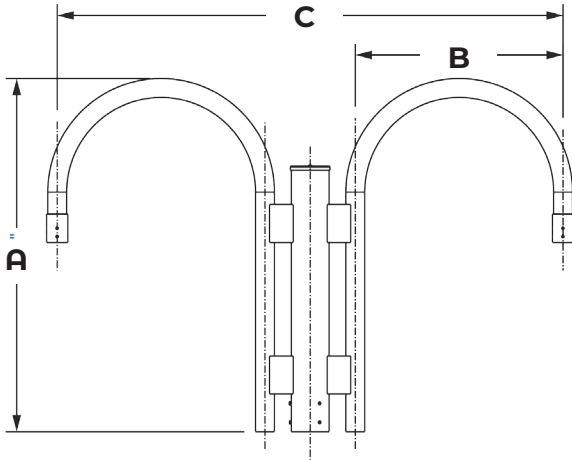
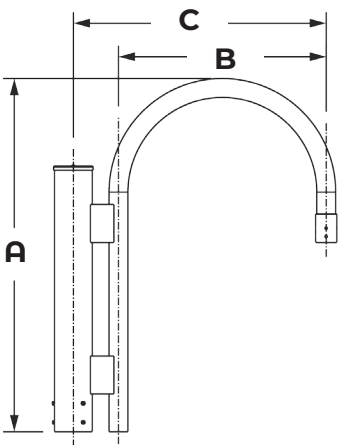

Dimensions				EPA
Cat#	A	B	C	EPA
DA6-SGL	37" 3/8	22"	26" 3/4	1.9
DA6-D180	37" 3/8	22"	53" 1/2	3.1
DA6-WM	33" 3/4	22"	26"	1.5

Example: (DA6-SGL-3-BLK)

DA-6			
Cat #	Mounting	Diameter (Pole or Tenon)	Color
Decorative Arm 6 (DA6)	Single (SGL)	3" OD (3)	Black (BLK)
	Double 180° (D180)	3 1/2 OD (312)	White (WH)
		4" OD (4)	Bronze (BRZ)
	Wall Mount (WM)	4 1/2 OD (412)	Silver (SIL)
		5"OD (5)	Graphite (GPH) Custom (CST)

Decorative Arm 7 is Constructed of Extruded Aluminum Tubing. Mount over Round Poles or Tenons of 3", 3-1/2", 4", 4-1/2", or 5" OD, **DA7** and is secured with 3/8" Stainless Steel Set Screws. Contact us for custom configuration or others mounting. All Decorative Arms are Proudly Designed, Fabricated and Assembled in the USA.

DA7-SGL

DA7-D180

DA7-wm

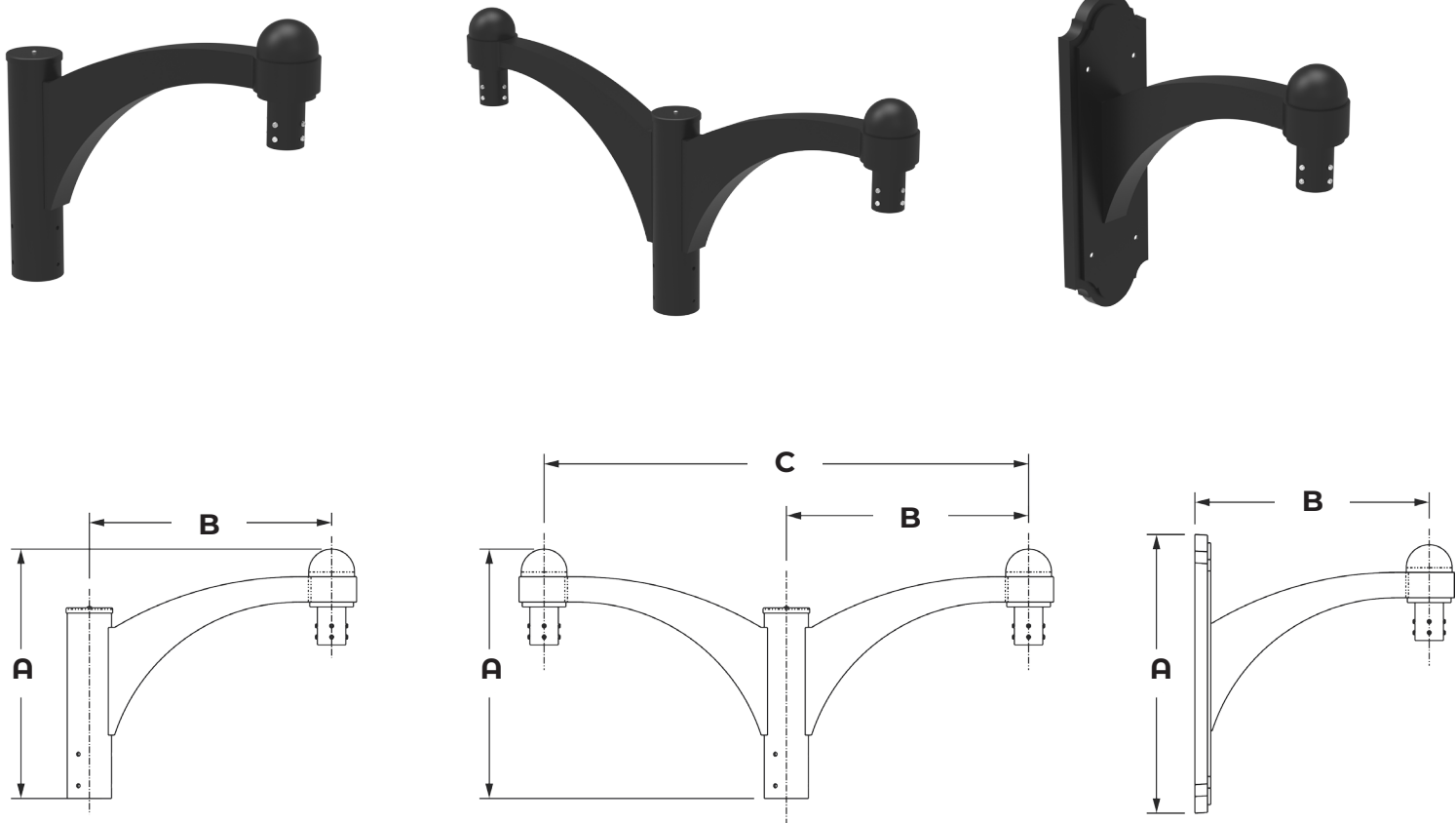

Dimensions				EPA
Cat#	A	B	C	EPA
DA7-SGL	19" 3/4	19" 1/4	-	.9
DA7-D180	19" 3/4	19" 3/4	38" 3/8	1.43
DA7-WM	18" 1/2	22"	-	.71

Example: (DA7-SGL-3-BLK)

DA7			
Cat #	Mounting	Diameter (Pole or Tenon)	Color
Decorative Arm 7 (DA7)	Single (SGL)	3" OD (3)	Black (BLK)
	Double 180° (D180)	3 1/2 OD (312)	White (WH)
		4" OD (4)	Bronze (BRZ)
	Wall Mount (WM)	4 1/2 OD (412)	Silver (SIL)
		5"OD (5)	Graphite (GPH) Custom (CST)

Decorative Arm 8 is Constructed of Extruded Aluminum Tubing. Mount over Round Poles or Tenons of 3", 3-1/2", 4", 4-1/2", or 5" OD, **DA8** and is secured with 3/8" Stainless Steel Set Screws. Contact us for custom configuration or others mounting. All Decorative Arms are Proudly Designed, Fabricated and Assembled in the USA.

DA8-SGL

DA8-D180

DA8-wm

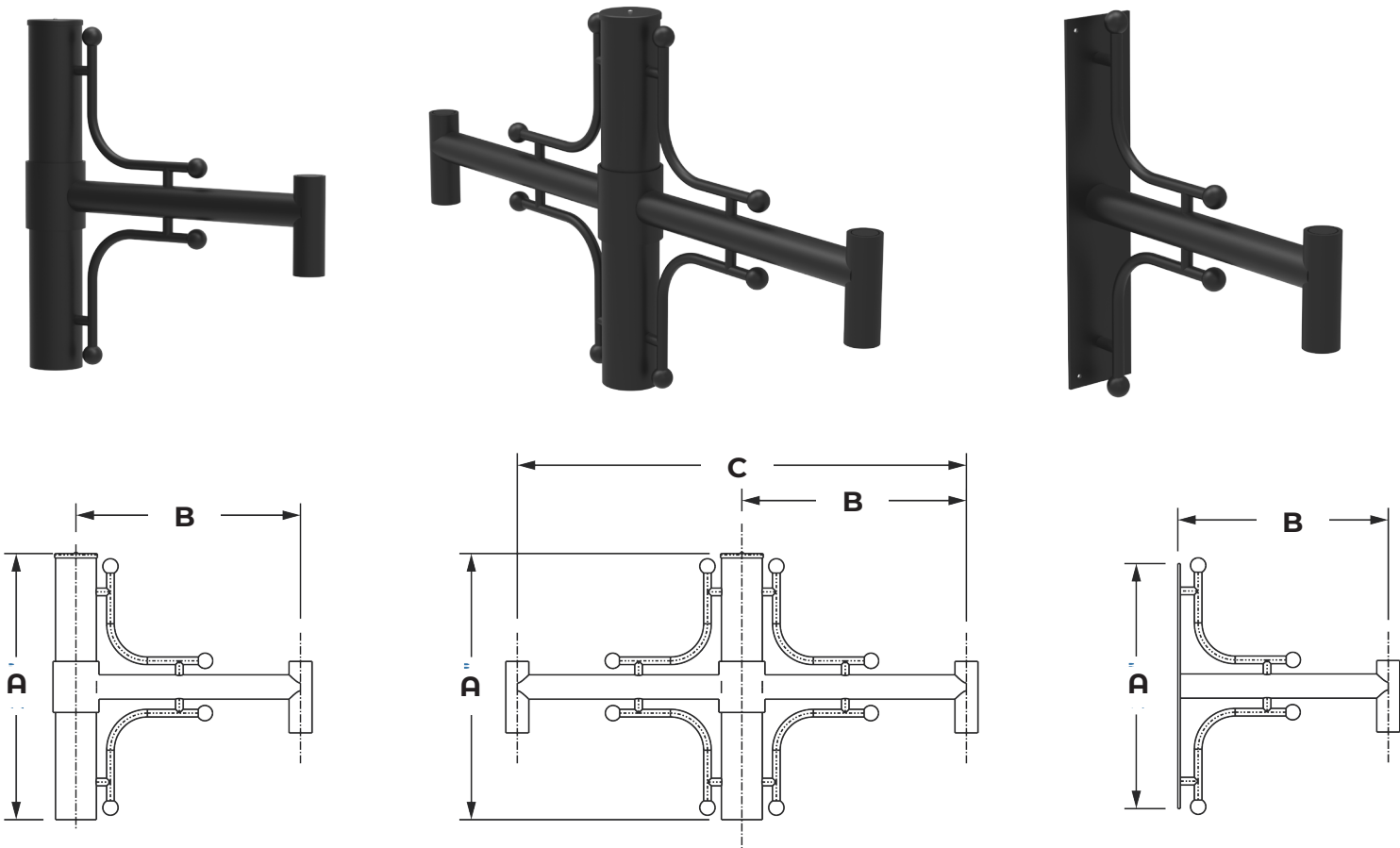

Dimensions				EPA
Cat#	A	B	C	EPA
DA8-SGL	26"	22"	-	1.39
DA8-D180	26"	22"	44"	2.03
DA8-WM	24"	20" 5/8	-	.70

Example: (DA8-SGL-3-BLK)

DA8			
Cat #	Mounting	Diameter (Pole or Tenon)	Color
Decorative Arm 8 (DA8)	Single (SGL)	3" OD (3)	Black (BLK)
	Double 180° (D180)	3 1/2 OD (312)	White (WH)
		4" OD (4)	Bronze (BRZ)
	Wall Mount (wm)	4 1/2 OD (412)	Silver (SIL)
		5"OD (5)	Graphite (GPH)
			Custom (CST)

Decorative Arm 9 is Constructed of Extruded Aluminum Tubing. Mount over Round Poles or Tenons of 3", 3-1/2", 4", 4-1/2", or 5" OD, **DA9** and is secured with 3/8" Stainless Steel Set Screws. Contact us for custom configuration or others mounting. All Decorative Arms are Proudly Designed, Fabricated and Assembled in the USA.

DA9-SGL

DA9-D180

DA9-WM

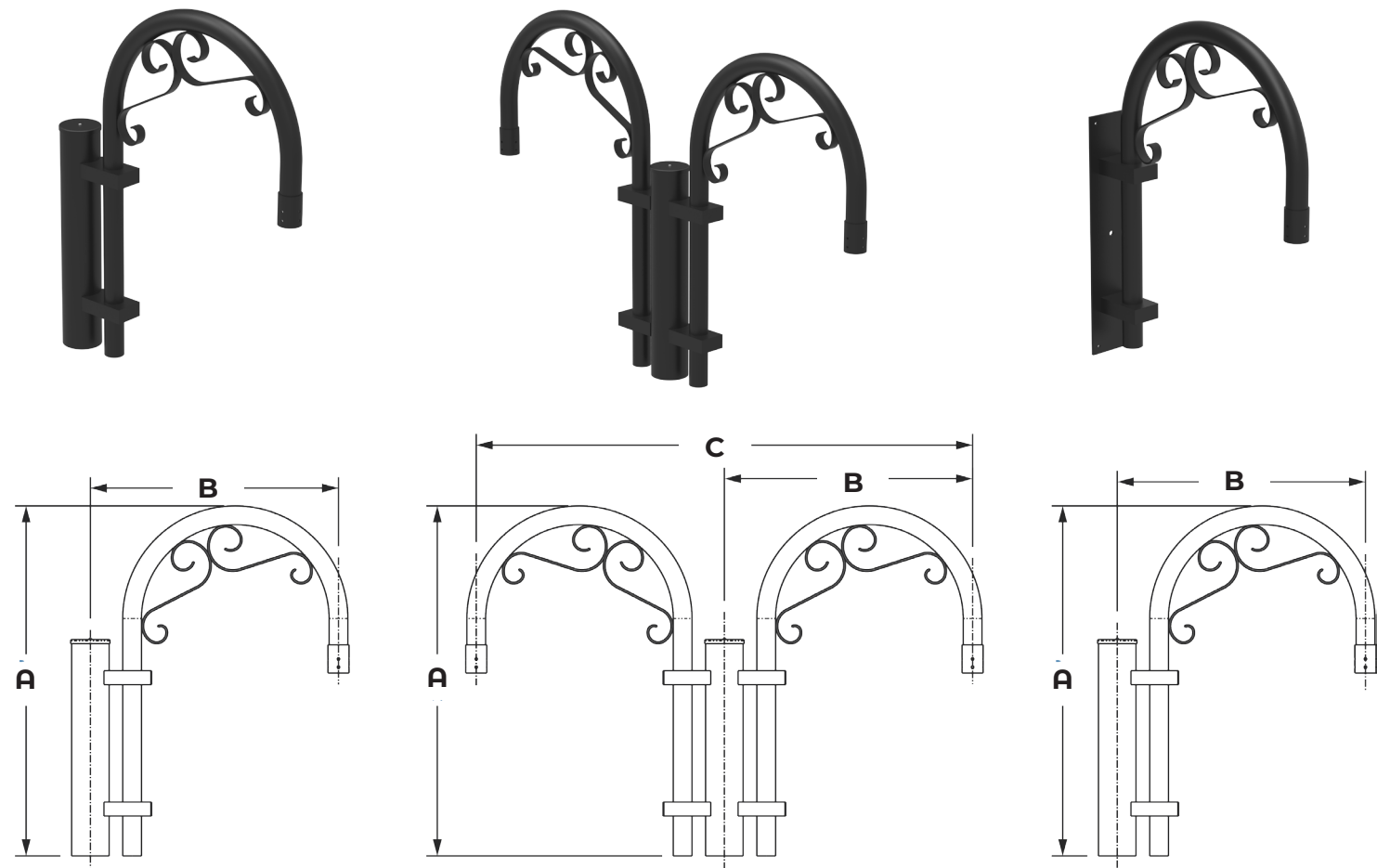

Dimensions				EPA
Cat#	A	B	C	EPA
DA9-SGL	37" 3/8	26" 1/2	-	1.9
DA9-D180	37" 3/8	26" 1/2	53"	3.1
DA9-WM	34" 7/8	25" 1/4	-	1.5

Example: (DA9-SGL-3-BLK)

DA9			
Cat #	Mounting	Diameter (Pole or Tenon)	Color
Decorative Arm 9 (DA9)	Single (SGL)	3" OD (3)	Black (BLK)
	Double 180° (D180)	3" 1/2 OD (312)	White (WH)
		4" OD (4)	Bronze (BRZ)
	Wall Mount (WM)	4" 1/2 OD (412)	Silver (SIL)
		5"OD (5)	Graphite (GPH) Custom (CST)

Decorative Arm 10 is Constructed of Extruded Aluminum Tubing. Mount over Round Poles or Tenons of 3", 3-1/2", 4", 4-1/2", or 5" OD, **DA10** and is secured with 3/8" Stainless Steel Set Screws. Contact us for custom configuration or others mounting. All Decorative Arms are Proudly Designed, Fabricated and Assembled in the USA.

DA10-SGL



DA10-D180



DA10-WM

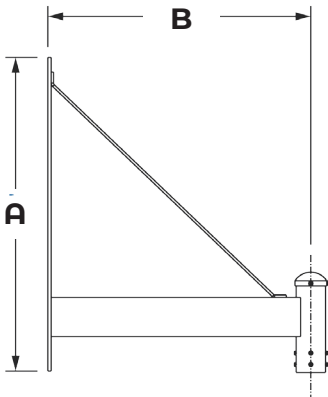
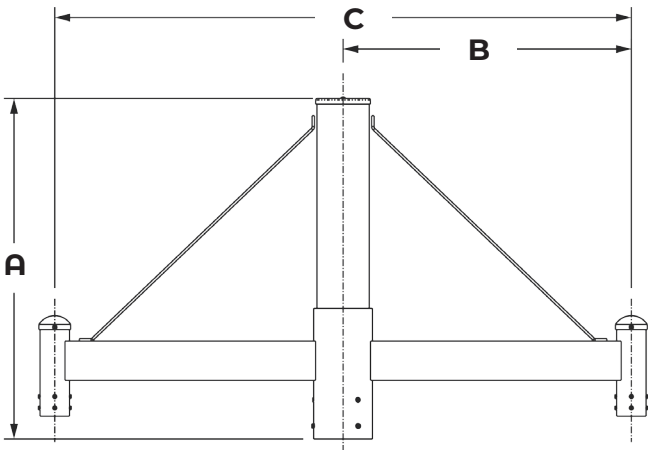
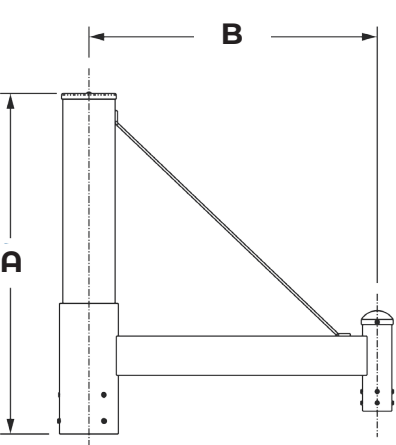
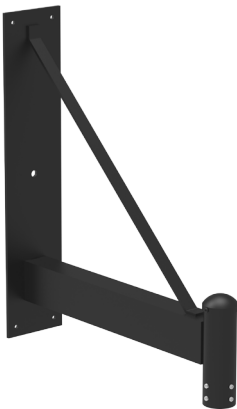

Dimensions				EPA
Cat#	A	B	C	EPA
DA10-SGL	26"	22"	-	1.27
DA10-D180	26"	22"	44"	1.82
DA10-WM	26"	22"	-	.7



Example: (DA10-SGL-3-BLK)

DA10			
Cat #	Mounting	Diameter (Pole or Tenon)	Color
Decorative Arm 10 (DA10)	Single (SGL)	3" OD (3)	Black (BLK)
	Double 180° (D180)	3" 1/2 OD (312)	White (WH)
		4" OD (4)	Bronze (BRZ)
	Wall Mount (WM)	4" 1/2 OD (412)	Silver (SIL)
		5"OD (5)	Graphite (GPH) Custom (CST)

CLP-X155 is Constructed of Extruded Aluminum Tubing. Mount over Round Poles or Tenons of 3", 3-1/2" or 4" OD, **CLP-X155** and is secured with 3/8" Stainless Steel Set Screws. Contact us for custom configuration or others mounting. All Decorative Arms are Proudly Designed, Fabricated and Assembled in the USA.

CLP-X155-SGL

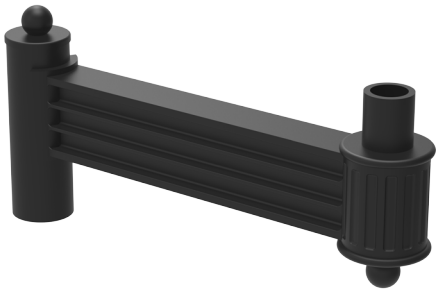

CLP-X155-D180

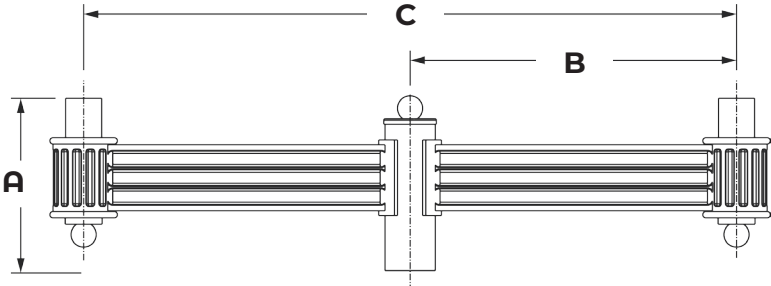
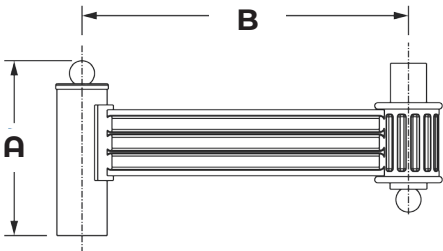

Dimensions				EPA
Cat#	A	B	C	EPA
CLP-X155-SGL	14"	26"	-	1.45
CLP-X155-D180	14"	26"	52"	2.55

Example: (CLP-X155-SGL-3-BLK)

CLP-X155			
Cat #	Mounting	Diameter (Pole or Tenon)	Color
CLP-X155 (CLP-X155)	Single (SGL) Double 180° (D180) Wall Mount (WM)	3" OD (3) 3" 1/2 OD (312) 4" OD (4)	Black (BLK) White (WH) Bronze (BRZ) Silver (SIL) Graphite (GPH) Custom (CST)

DA-M156 is Constructed of Extruded Aluminum Tubing and Cast Aluminum Arm (356 Alloy) . Arm mount over Round Poles or Tenons of 3", 3-1/2", 4", 4-1/2", or 5" OD, and is Secured with 3/8" Stainless Steel Set Screws. Contact us for custom configuration or others mounting.

All Decorative Arms are Proudly Designed, Fabricated and Assembled in the USA.

DA-M156-SGL



DA-M156-D180



DA-M156-WM

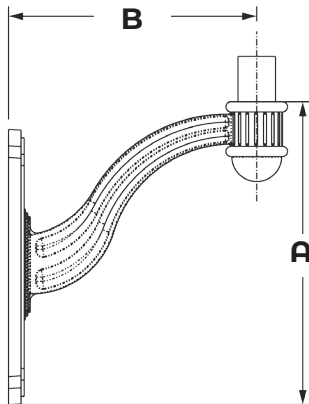
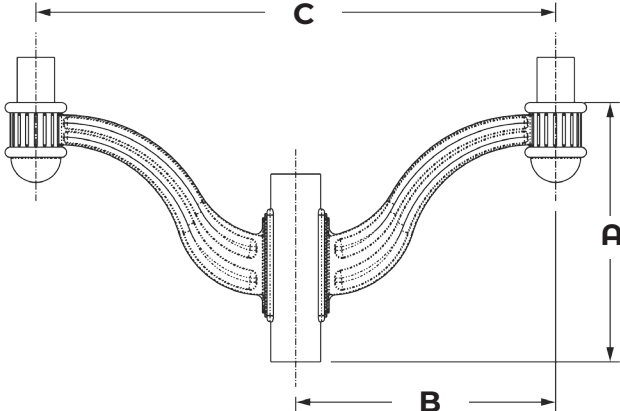
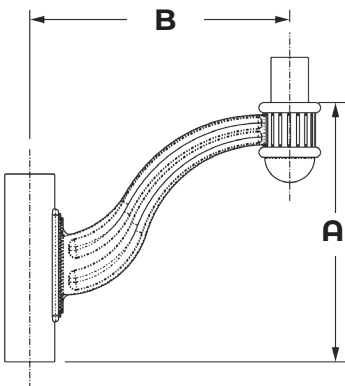

Dimensions				EPA
Cat#	A	B	C	EPA
DA-M156-SGL	20" 3/4	20" 7/8	-	1.18
DA-M156-D180	20" 3/4	20" 7/8	41" 5/8	1.36
DA-M156-WM	24" 1/4	19" 7/8	-	1.25



Example: (DA-M156-SGL-3-BLK)

DA-M156			
Cat #	Mounting	Diameter (Pole or Tenon)	Color
Decorative Arm M156 (DA-M156)	Single (SGL)	3" OD (3)	Black (BLK)
	Double 180° (D180)	3" 1/2 OD (312)	White (WH)
		4" OD (4)	Bronze (BRZ)
	Wall Mount (WM)	4" 1/2 OD (412)	Silver (SIL)
		5"OD (5)	Graphite (GPH) Custom (CST)

Decorative Arm X is Constructed of Extruded Aluminum Tubing. Mount over Round Poles or Tenons of 3", 3-1/2", 4", 4-1/2", or 5" OD, **DAX** and is secured with 3/8" Stainless Steel Set Screws. Contact us for custom configuration or others mounting. All Decorative Arms are Proudly Designed, Fabricated and Assembled in the USA.

CLP-X11-SGL

CLP-X11-D180

CLP-X11-WM

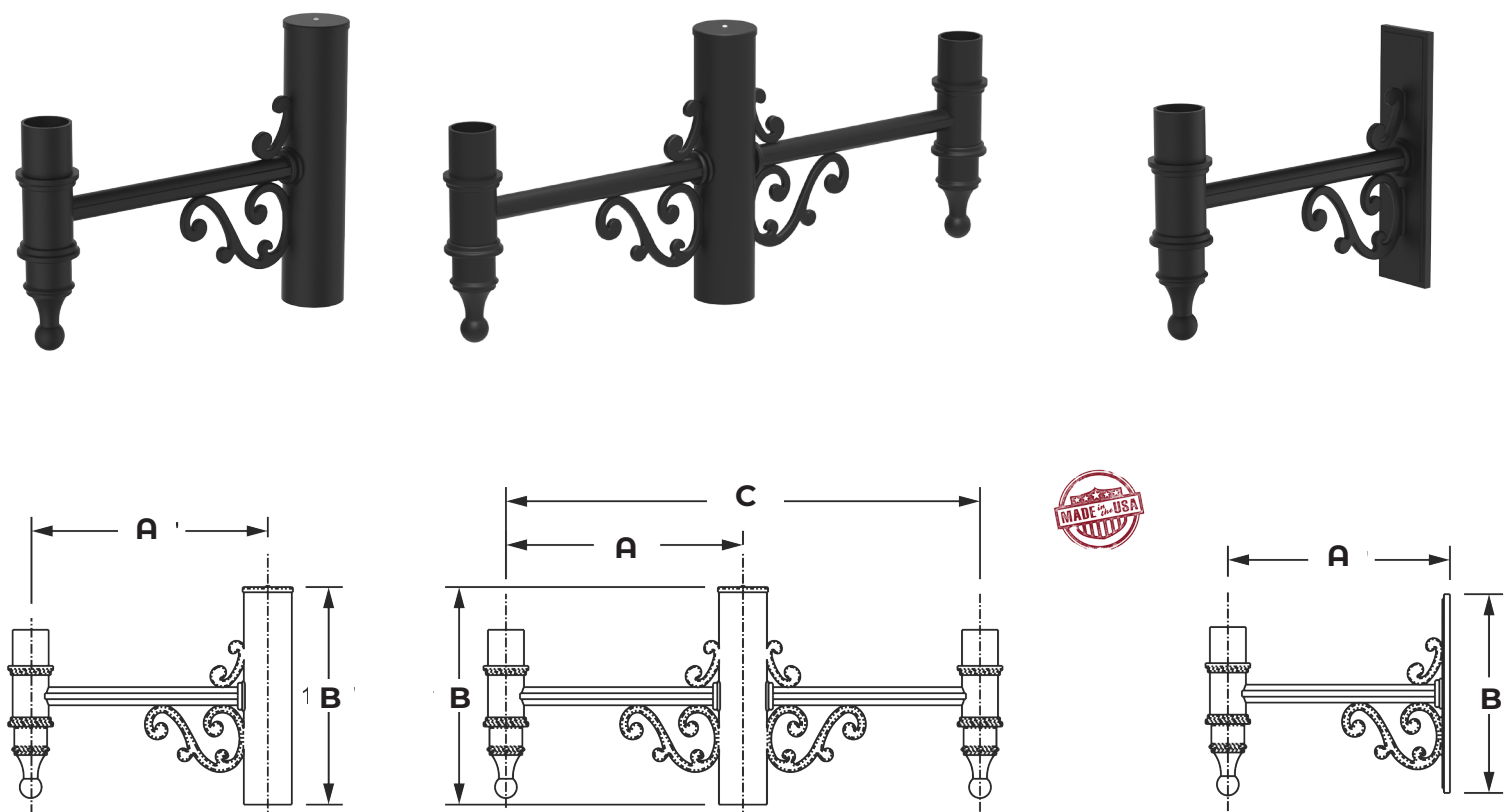

Dimensions (Average)					EPA
Cat#	Size	A	B	C	EPA
CLP-X11-SGL	sm	8" 3/4	18"	-	.7
	mED	11"	18"	-	.8
	LG	14"	18"	-	.9
	XLG	20"	18"	-	1.07
CLP-X11-D180	sm	8" 3/4	18"	18"	1.3
	mED	11"	18"	22"	1.4
	LG	14"	18"	28"	1.5
	XLG	20"	18"	40"	1.64

Dimensions (Average)				EPA
Cat#	Size	A	B	EPA
CLP-X11-WM	sm	6" 3/4	9"	.3
	mED	9"	12"	.4
	LG	12"	16"	.5
	XLG	18"	22"	.64

Example: (CLP-X11-SGL-3-BLK)

CLP-X11			
Cat #	Mounting	Diameter (Pole or Tenon)	Color
CLP-X11 (CLP-X11)	Single (SGL) Double 180° (D180) Wall Mount (WM)	3" OD (3) 3 1/2 OD (312) 4" OD (4) 4 1/2 OD (412) 5"OD (5)	Black (BLK) White (WH) Bronze (BRZ) Silver (SIL) Graphite (GPH) Custom (CST)

CLP-246B is Constructed of Extruded Aluminum Tubing. Mount over Round Poles or Tenons of 3", 3-1/2", 4", 4-1/2", or 5" OD, **CLP-246B** is secured with 3/8" Stainless Steel Set Screws. Contact us for custom configuration or others mounting. All Decorative Arms are Proudly Designed, Fabricated and Assembled in the USA.

CLP-246B-SGL

CLP-246B-D180

CLP-246B-WM

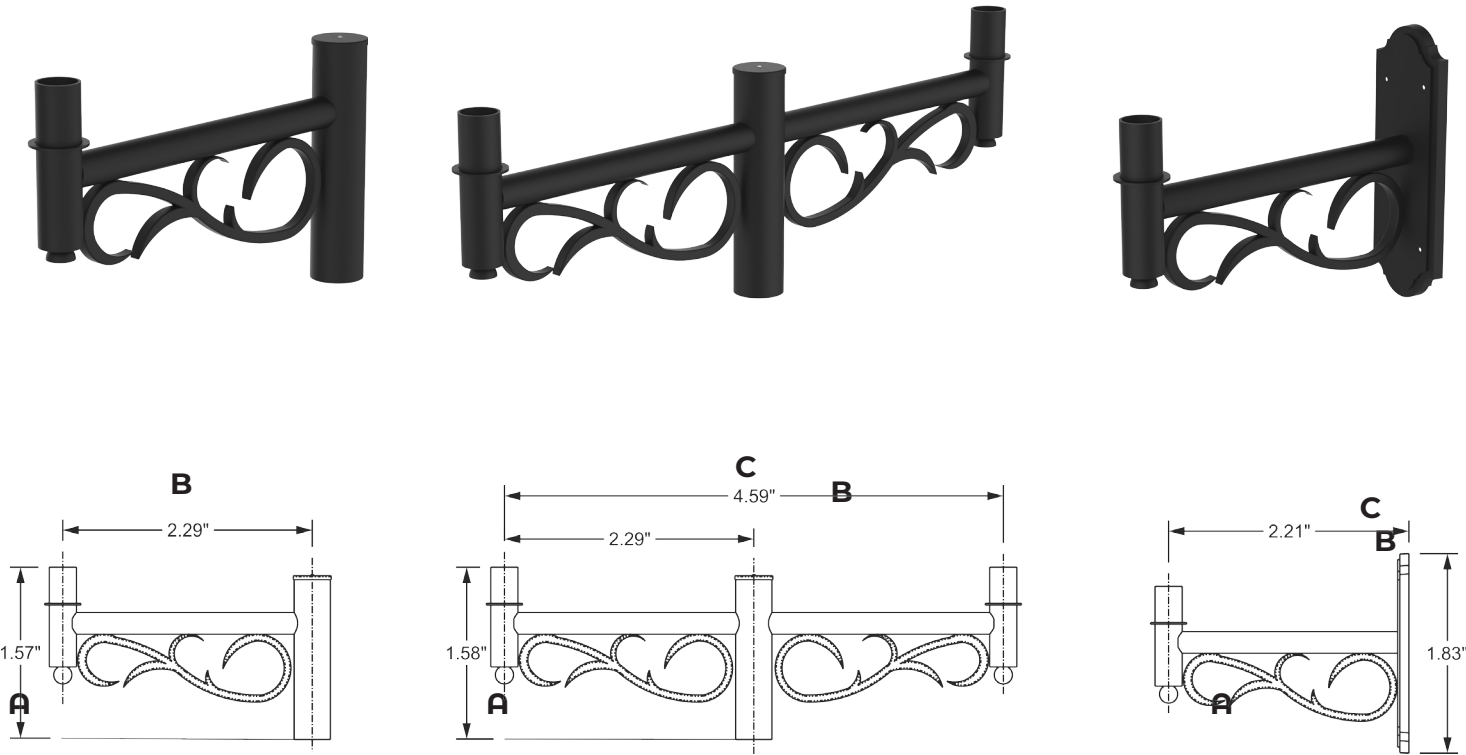

Dimensions				EPA
Cat#	A	B	C	EPA
CLP-246B-WM	18"	20"	-	1.11
CLP-246B-SGL	20"	18"	-	1.43
CLP-246B-D180	20"	18"	40"	2.36

Example: (CLP-246B-SGL-3-BLK)

CLP-246B			
Cat #	Mounting	Diameter (Pole or Tenon)	Color
CLP-246B	Single (SGL)	3" OD (3)	Black (BLK)
	Double 180° (D180)	3" 1/2 OD (312)	White (WH)
		4" OD (4)	Bronze (BRZ)
	Wall Mount (WM)	4" 1/2 OD (412)	Silver (SIL)
		5"OD (5)	Graphite (GPH) Custom (CST)



Crystal Lighting
13182 Flores ST.
Santa Fe Springs , CA. 90670
Ph: 562-944-0223
www.crystallighting.us

Proudly manufactured and assembled in the USA